

For examples of OVER 6100 available products visit www.moodie.com.au

RESOURCE GUIDE 10.1.2



Moodie
Outdoor Products



Ausrooms
relocatable - prefabricated
www.ausrooms.com.au

• EUROMODUL • RELOCATABLE EUROTAINERS



* Large standard range

* Custom work is welcomed



sales@moodie.com.au • 1300 666 343 connects you to your local representative

PO Box 3040 Monash Park NSW 2111 Australia

www.moodie.com.au

Relocatable EuroTainers

Australian Market

Release Jan 2012



4. FLAT PACK packed container modules

FLAT-PACK Individual modules
 Save transportation cost.
 Can be used independent, individual or as part of a system of modular building structures.
 Layout- Select
 9719 1148, 9719 1147, 9719 1141, 9719 1106 or 9719 1103 styles.



FLAT PACK container ▲

▶ roof lifting



▲ pillar tightening

▶ wall mounting

9719 2102 ▶



FLAT PACK containers

Benefits for distant locations
 reduced transport dimensions.

When compared to standard containers, FLAT PACK requires up to 4 times less transport space.

The time for assembly on site (two persons) is approximately 45 minutes.

EUROmodul FLAT PACK container fully assembled ▼ 9719 2103

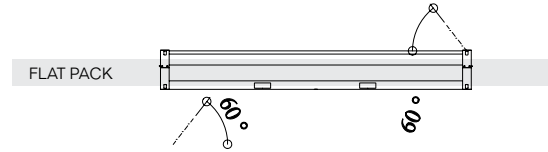

Lifting by crane one by one, or with forklift

Truck can handle up to 4 (or 8) containers in FLAT PACK.
 Each unit is 650 mm in height if wall panels are up to 100 mm
 Each unit is 700 mm in height

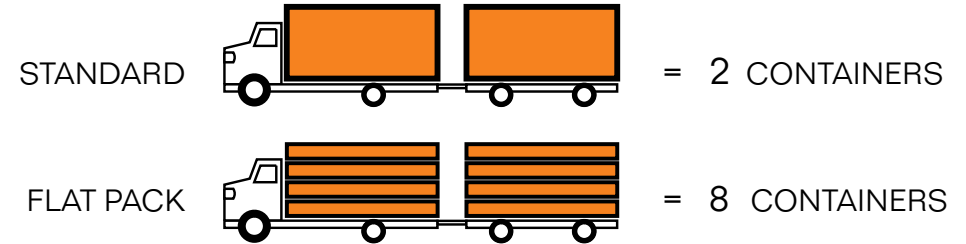

9719 2101 ▼

FLAT PACK CONTAINERS ready for shipping Note 5 high



Relocatable EuroTainers



97191157 Type container with exterior power connections (2 pcs) inside construction, one door two windows it also consists of forklift openings, painted to client's specifications. Shown - in blue colour

9719 1191

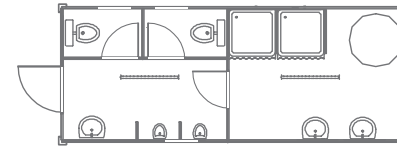

▲ **1191** sanitary container 6,0 x 2,4
 Insulated, 2 toilet cabins, 3 wash basins, 2 urinals, 2 shower cubicles
 PVC floor

9719 1192

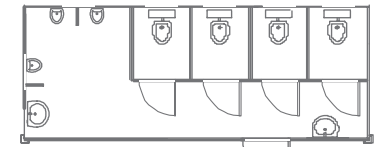

▲ **1192** sanitary container 6,0 x 2,4 m
 Insulated, 2 wash basins, 3 urinals, 4 Toilet cubicles, PVC floor

9719 1194

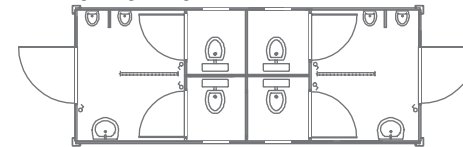

▲ **1194** sanitary container 6,0 x 2,4 m
 Insulated, two wash basins, 4 urinals, 4 Toilet cubicles, ceiling lights, PVC floor

9719 1193

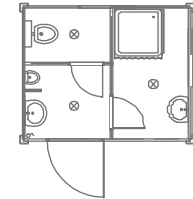

▲ **1193** sanitary container 3,0 x 2,4 m,
 Insulated, two wash basins, urinal, Toilet cabin, shower cubicle, ceiling lights, PVC floor

9719 1147

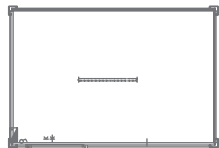

▲ **1147** Office container, 3,0 x 2,4 m
 Insulated, door, PVC floor
 cables, fuses, socket, ceiling light,

9719 1148

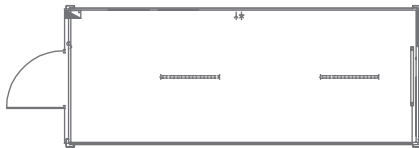

▲ **1148** Office container 6,0 x 2,4 m
 Insulated, door, cables, fuses, sockets, 2 ceiling lights, PVC floor

9719 1103

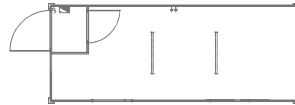

▲ **1103** Office container 6,0 x 2,4 m
 Insulated, door, cables, fuses, sockets, 2 ceiling lights, PVC floor

9719 1195

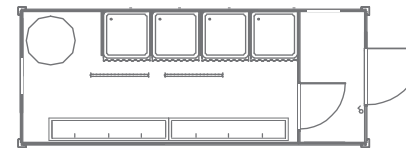

▲ **1195** sanitary container dimensions 6,0 x 2,4 m,
 Insulated, two doors, 4 shower cabins, hot water unit, 2 washing basins, ceiling lights, PVC floor

9719 1173

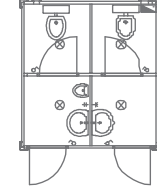

▲ **1173** sanitary container, 1,8 x 2,4 m
 Insulated, 2 toilet cubicle, 2 wash basin, 1 urinal, PVC floor

9719 1141

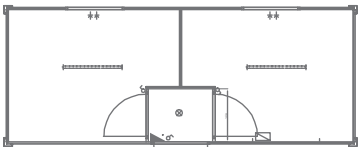

▲ **1141** Office container, 6,0 x 2,4 m,
 itwo spaces and lobby, 3 doors, 2 windows, Insulated, PVC floor, cables, fuses, 5 sockets, 3 ceiling lights

9719 1157

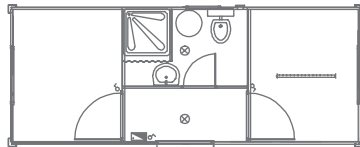

▲ **1157** Office container, 6,0 x 2,4 m,
 two spaces and lobby with toilet, wash basin and shower, 4 doors, 3 windows, Insulated, PVC floor, cables, fuses, 5 socket, 3 ceiling lights and hot water unit

9719 1108

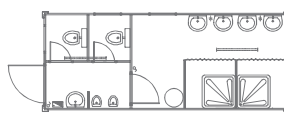

▲ **1108** sanitary container dimensions 6,0 x 2,4 m,
 Insulated, two toilet cubicles, 2 showers, Hot water unit, 2 urinals 5 washing basins, ceiling lights, PVC floor

9719 1106

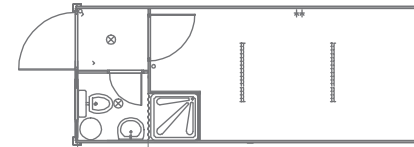

▲ **1106** Office container 6,0 x 2,4 m with lobby and equipped toilet and shower, two doors, three windows, Insulated, cables, fuses, two ceiling lights, two sockets, 1 basin, PVC floor

9719 1107

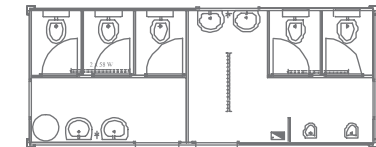

▲ **1107** sanitary container 6,0 x 2,4 m itwo spaces: 5 Toilet cubicles, 4 wash basins, 2 urinals, one Hot water unit, Tiled floor, Insulated,

Australian Regulations for Plumbing, Electricity and Waterproofing do apply. Cavity, draw wires and Australian Standards fittings for plumbing & electrical will be supplied. Disabled toilet designs are available. Complying to ASA 1428.1-2009.

Relocatable EuroTainers



container systems | EUROMODUL



1171
 sanitary container
 1,2 x 2,4 m

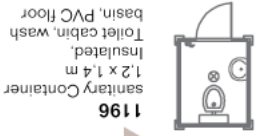

1196
 sanitary container
 1,2 x 1,4 m



1171
 sanitary container,
 1,2 x 2,4 m



1171mod
 sanitary container,
 1,2 x 2,4 m



1197
 sanitary container,
 2,4 x 1,4 m

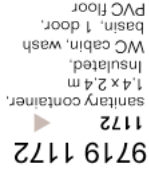

1172
 sanitary container,
 1,4 x 2,4 m



1180
 sanitary container,
 2,4 x 2,4 m

Container toilets are suitable for temporary public or business facilities as well as for construction sites, bush tourist camps, beaches and sporting events.

EUROModul sewage holding tanks are available for sites where no sewer connection is available.

Water tanks are also available for sites where no mains water is available.



Tanks can be incorporated into the foundation or placed separately.

9719 2182



9719 2180

EUROModul sewage holding tanks are available for sites where no sewer connection is available.



9719 2190

Containers can be enhanced with colours and architectural elements such as attics and vented roofs.

3. Individual modules
 Basic modul
 Container for GSM equipment with secondary roof, zinc protected construction, painted, or in stainless steel on request
 special containers - telephone, television and radio signal operating units.
Higher specifications
 Special coatings to waterproof; insulation materials, better floor load capability.

9719 4603
 container 4603 02
 dimensions 2,4 x 2,4 m
 stainless steel construction
 with secondary roof



Australian Regulations for Plumbing, Electricity and Waterproofing do apply. Cavity, draw wires and Australian Standards fittings for plumbing & electrical will be supplied.